

**PRIVATE SEWAGE SYSTEM  
INSPECTION REPORT for Dunn County**

Name	Thomas Stocklen	
Address	E2573 530th Ave.	
City	Menomonie	
State & Zip	WI	54751

Address	E2603 530th Ave. Menomonie, WI 54751
Town of	Lucas
Legal	NE, SE 26-28-14
Sanitary permit #	233240
State Plan ID #	S95-40508
Parcel tax #	281426.401
Computer #	014-1072-07

**GENERAL INFORMATION**

CST BM Elev.: 100'	Insp. BM Elev.: 100'	BM Description: at grade by steel stake
-----------------------	-------------------------	--

**TANK INFORMATION**

TYPE	MANUFACTURER	CAPACITY
Septic	Skaw	1000
Dosing	Shaw	800
Holding		

**ELEVATION DATA**

STATION	ELEVATION	ELEVATION
Benchmark		100.00
Well		
Bldg. Sewer		
St/Ht Inlet		98.82
St/Ht Outlet		98.40
Dt inlet		93.42
Dt Bottom		89.80
Header/Man.		98.69
Dist. pipe		98.72
Bottom system		98.00
Final Grade		

**TANK SETBACK INFORMATION**

TYPE	P/L	WELL	BLDG	VENT TO AIR INTAKE
Septic	>100'	85'	*	
Dosing	>100'	174'	*	*
Holding				

**PUMP/SIPHON INFORMATION**

Manufacturer	Zoellen		
Model number	#98A		
Lift 8.89	Friction Loss .5	System Head 2.5	TDH 11.89 Ft.
Forcemain	Length 76'	Dia. 2"	Dist. to Well 183'

**SOIL ABSORPTION SYSTEM**

Bed/trench dimensions	Width 5'	Length 75'	No. of Trenches		
Setback	Type of System	P/L	Bldg	Well	Lake/Stream
Information	mound	>100'	*	225'	

**DISTRIBUTION SYSTEM**

Header/Manifold Length Dia.	Distribution pipe(s) Length 70' Dia. 2" Spacing	X Hole Size 1/4"	X Hole Spacing 60"	Vent to Air intake
--------------------------------	--	---------------------	-----------------------	-----------------------

**COMMENTS:**

\* Mobile home not on-site at time of inspection.

Plan revisions required?  yes  no

6/19/95  
date

*Michael Helgeson*  
Inspector's Signature

0052  
Cert. No.

316 21  
1710 21

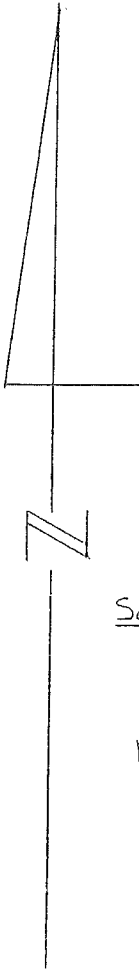
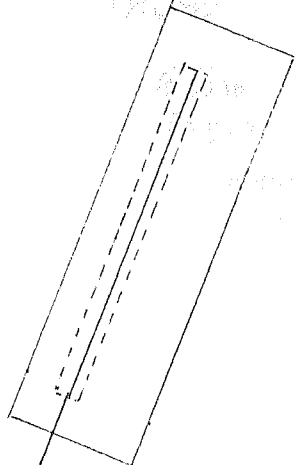

Scale : 1" = 40'

PART OF 40 ACRES  
No NEAR BY LOT LINES



APPROX. LOCATION OF PROPOSED  
MOBILE HOME

WELL

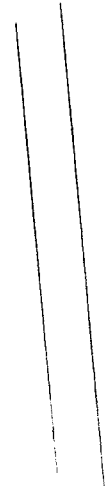

PRUDNE DRIVE



Tom Stocken

Chris #  
279-3931

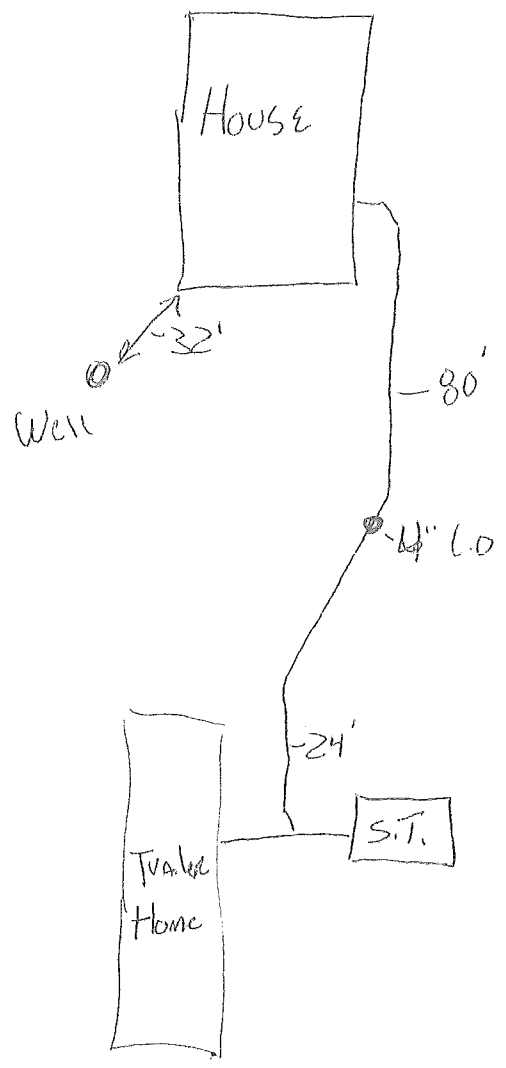

Septic Inlet	9.5'
B.S.	6.2'
Top of Well	6.6'

After Tom Move's into the house the trailer  
is going to be moved out.